

Scale 200 P^s to the Inch

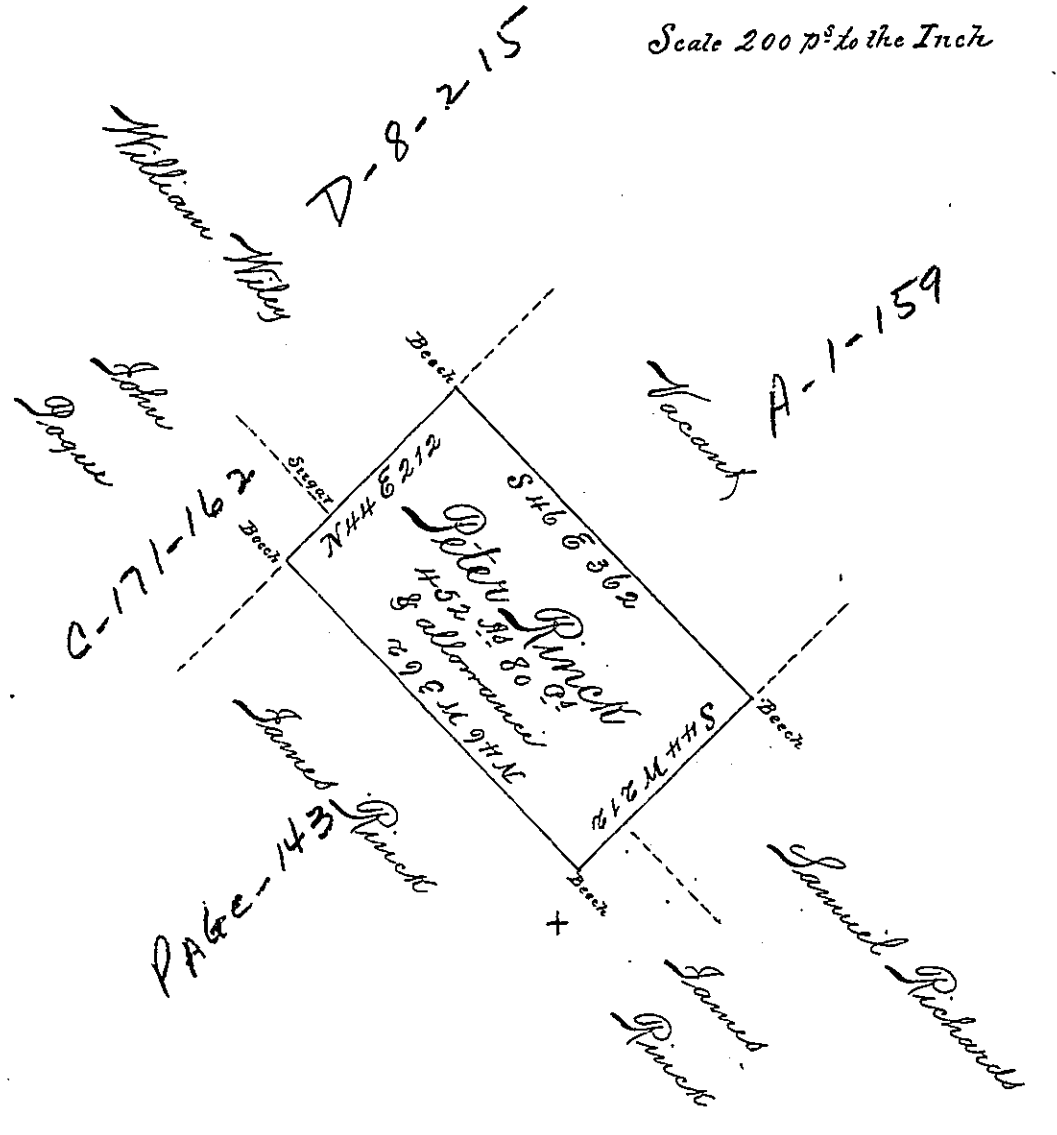

Draught of a Tract of Land called Rincks Bottom
 situate on Tunkhannock Creek adjoining Lands
 of James Rinck and others in the County of Luzerne
 containing Four hundred and Fifty two Acres
 and Eighty Perches and the usual Allowance of
 Six per Centum for Roads surveyed for Peter Rinck
 the fifth Day of May One thousand Seven hundred and
 Eighty nine by William Gray Esquire late Deputy Surveyor
 in Pursuance of a warrant bearing Date the 9th Day of October
 1788 and certified by me this 23rd Day of ^{October} ~~November~~ 1802

Tho^s Sambourn
 Surveyor

To Samuel Cochran Esq
 Surveyor General

N.B. It will be of Advantage to the State to receive this Return as there will be
 otherwise a small Vacancy which will be of no use to retain J.S.

IN TESTIMONY that the above is a copy of the original remaining on file in the
 Department of Internal Affairs of Pennsylvania, made con-
 formably to an Act of Assembly approved the 16th day of
 February, 1833. I have hereunto set my Hand and caused
 the Seal of said Department to be affixed at Harrisburg, this
 third day of December 1895.

James Watt
 Secretary of Internal Affairs.